

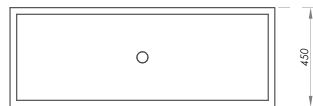

PLANTER TABULA

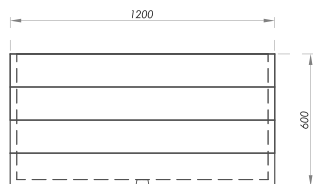

TOP VIEW



FRONT VIEW

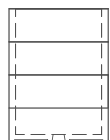

SIDE VIEW

DIMENSIONS: 47.24"x17.72" x23.62"
APPROXIMATE WEIGHT: 275.58lb
COLORS

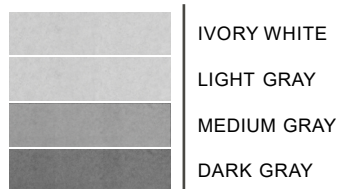

The available colors are exclusive, with a visible finish.

WATER TRAY

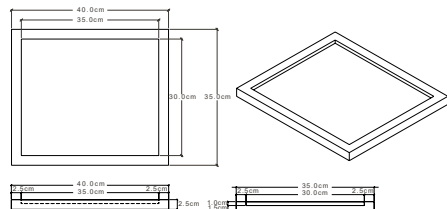

BASE

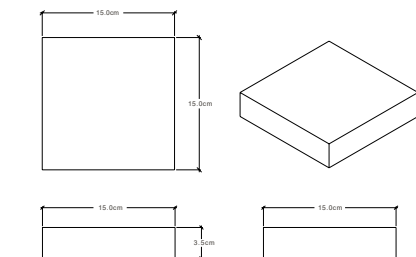

PRODUCT INFORMATION

The Tábula Planter is a prefabricated architectural concrete element by Opticretos with dimensions L: 47.24", W: 17.72", H: 23.62", and a weight of 275.58lb. Designed for outdoor use, it is resistant to vandalism and heavy-duty usage. Planters are a good choice for public and private spaces such as schools, universities, parks, corporate areas, residential areas, industrial plants, hospitals, etc.

MANUFACTURING

Our planters are made using special molds. The concrete is processed using automated machinery, ensuring the highest quality in materials. All our products are manufactured in the plant under controlled conditions.

COMPONENTS

We use materials such as marble cementing agents, anti-fungal additives, alkali-resistant polypropylene fibers, integral waterproofing additives, and hydrophobic sealer.

ADVANTAGES



Stain-resistant



Durability



Easy installation



Environmentally sustainable



Su mantenimiento es mínimo y el color no cambia ni se degrada con el tiempo ya que se utilizan materiales naturales.

CODES AND REGULATIONS

All our concrete products comply with current regulations. Some of these codes include: ACI 318, PCI (Precast Concrete Institute), IMCYC (Mexican Institute of Cement and Concrete), and the Building Regulations of the Federal District.

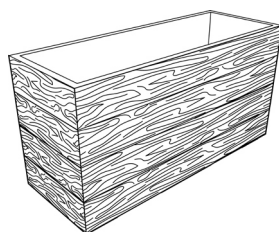
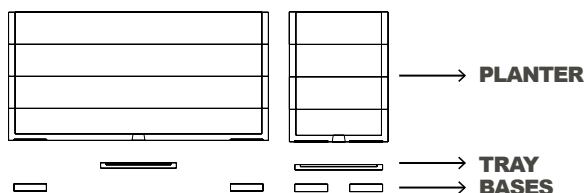

FOLLOW US ON SOCIAL MEDIA



INSTAGRAM



FACEBOOK



WWW.